



Mr. Winter Walk-in Coolers & Freezers

Flush Door Hinge Adjustment Instructions



800-327-3371
www.mrwinterinc.net



Flush Door Hinge Adjustment

DIRECTIONS

1. Remove access cover by depressing point "A" and pulling it outward.
2. Loosen 4 mounting screws on each strap, but do not remove screws.
3. Open door to break seal with magnetic gasket.
4. Adjust tip of door up by turning top hinge adjustment screw clockwise (opposite for left-hand door), and the bottom hinge adjustment screw counter-clockwise (opposite for left-hand door). Continue adjusting until door spacing is even.
5. Tighten 4 mounting screws on each hinge.
6. Replace cover by inserting point "A" first.

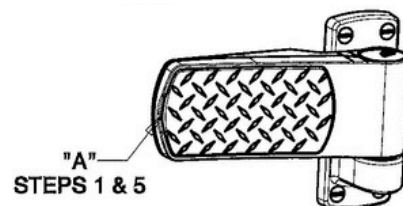
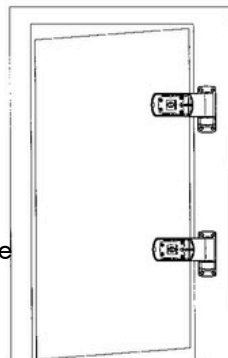

To Adjust Door Sag

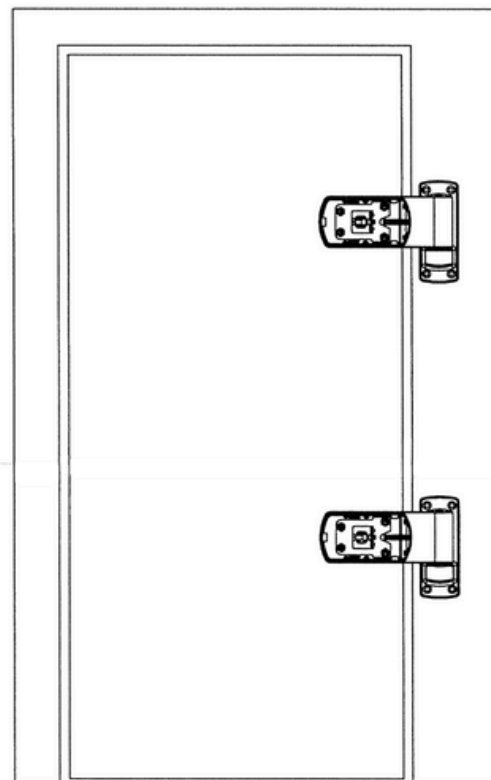
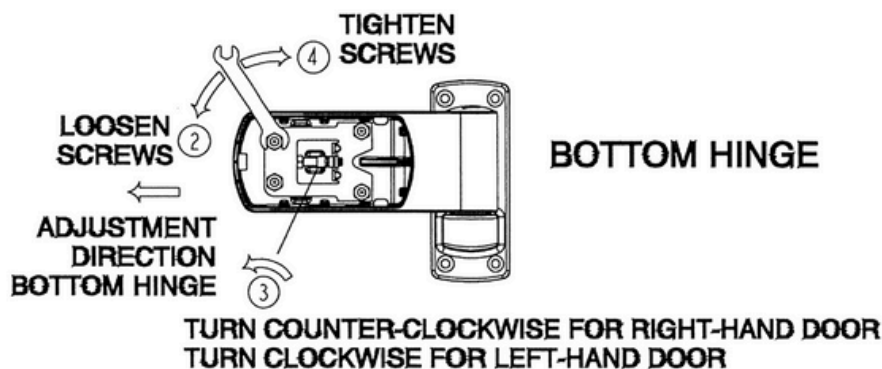
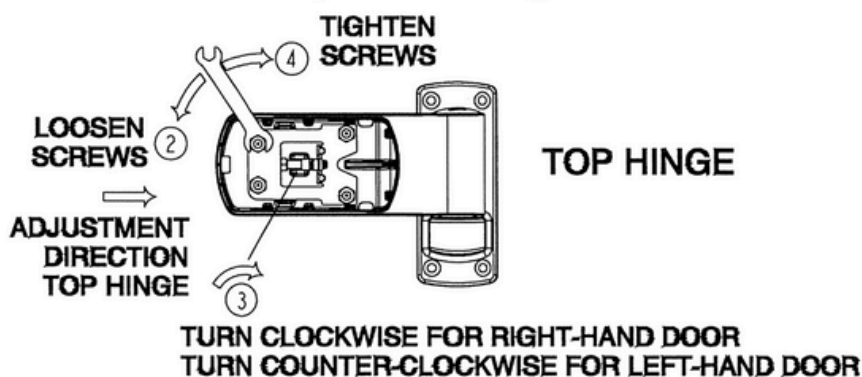

800-327-3371
www.mrwinterinc.net